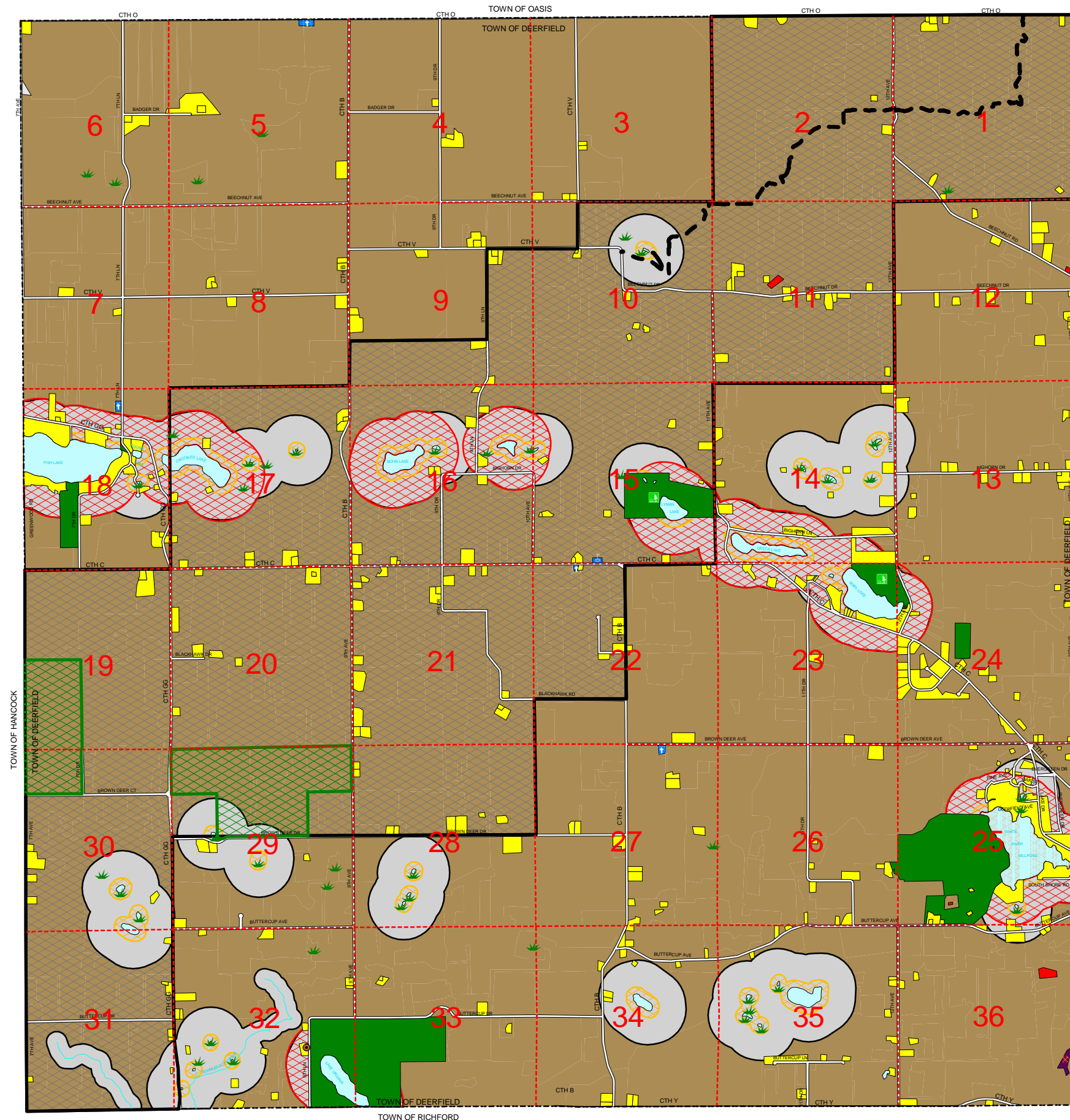

EXHIBIT 5-1 TOWN OF DEERFIELD PROPOSED LAND USE PLAN



PROPOSED LAND USES

Resource Protection Areas:
FEMA 100 Year Floodplains, greater than 5 acre Wetlands with 50 ft buffer,
75 ft Shoreland Buffer and 100 ft buffer from Class I, II, & III trout streams.
(Waushara County Hydro Data was used in the buffering process.)

Development Areas:

- Minimum Lot Size 1 Acre (200 ft. buffer from lakes) *
- Minimum Lot Size 3 Acres (1000 ft buffer from lakes) *
- Minimum Lot Size 5 Acres

* Minimum 1 acre lot sizes are in areas that front upon a lake, river or stream.
* Minimum 3 acre lot sizes are on backlots within shoreland areas.

EXISTING LAND USES

- RESIDENTIAL*
- MULTI-FAMILY / GROUP QUARTERS / RETIREMENT HOMES
- MOBILE HOME PARKS
- COMMERCIAL
- INDUSTRIAL
- MINING / QUARRY SITES
- PARKS AND RECREATION
- TRANSPORTATION / ROADS / RAILROADS
- UTILITIES
- INSTITUTIONAL FACILITIES
- WATER FEATURES

*Single Family Residences, Duplexes, Accessory Garages, Farmsteads, and Outbuildings.

Other Features:

- DNR Owned Lands
- Ice Age Corridor
- Wetlands less than 5 acres in size
- Ice Age Trail
- Town Hall
- Cemetery
- Parks
- Active Quarry
- Abandoned Landfill

Sources:

Digital Base Data provided by Waushara County.
Existing Land Use collected by ECWRPC.
Floodplains provided by FEMA.
Wetlands provided by the WDNR.

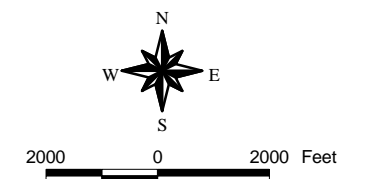

This data was created for use by the East Central Wisconsin Regional Planning Commission Geographic Information System. Any other use/application of this information is the responsibility of the user and such use/application is at their own risk. East Central Wisconsin Regional Planning Commission disclaims all liability regarding fitness of the information for any use other than for East Central Wisconsin Regional Planning Commission business.

Prepared By
EAST CENTRAL WISCONSIN
REGIONAL PLANNING COMMISSION - June, 2004