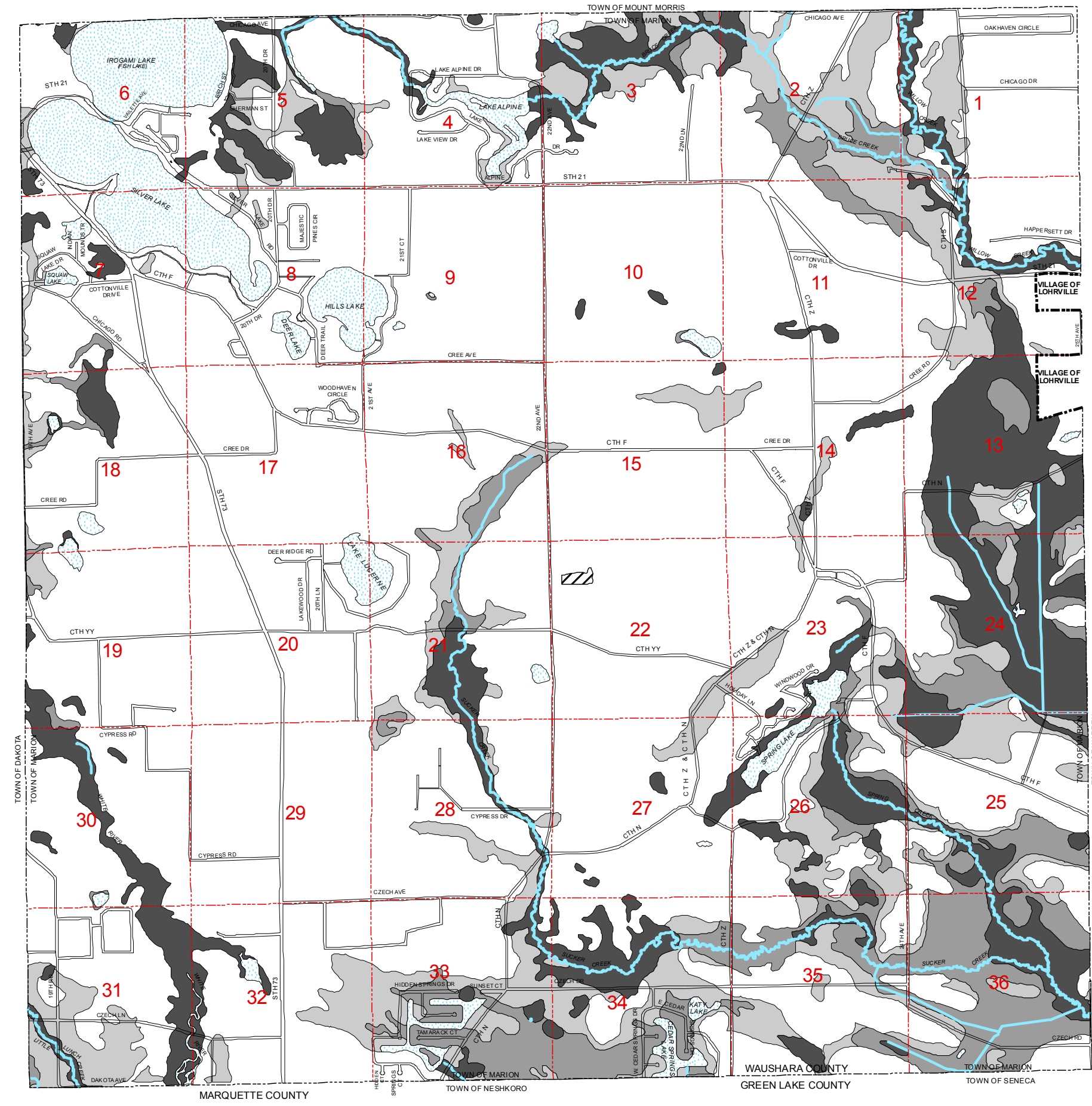





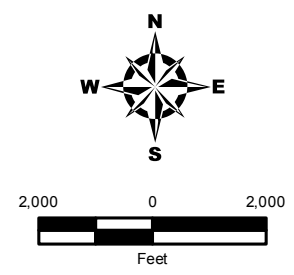

EXHIBIT 7-2 TOWN OF MARION SOIL LIMITATIONS FOR ON-SITE WASTE DISPOSAL



-  SOILS SUITABLE FOR CONVENTIONAL SEPTIC SYSTEMS
-  SOILS SUITABLE FOR AT-GRADE, IN-GROUND PRESSURE OR MOUND SYSTEMS
-  SOILS SUITABLE FOR HOLDING TANKS
-  SOILS UNSUITABLE FOR PRIVATE SEWAGE SYSTEMS
-  NO RATING
-  WATER

Source: USDA-SCS, Soil Survey of Waushara County, Wisconsin, 1982.
Digital Soils Data provided by NRCS.
Digital Base Data provided by Waushara County.



This data was created for use by the East Central Wisconsin Regional Planning Commission Geographic Information System. Any other use/application of this information is the responsibility of the user and such use/application is at their own risk. East Central Wisconsin Regional Planning Commission disclaims all liability regarding fitness of the information for any use other than for East Central Wisconsin Regional Planning Commission business.

Prepared By
EAST CENTRAL WISCONSIN
REGIONAL PLANNING COMMISSION-MARCH 2006